

Main Specifications**▼Installation**

Wall type (AT-THM801)

Duct type (AT-THM802)

Remote type (AT-THM803)

▼Electrical connector

M12-4PIN connector

M12-8PIN connector

M16 metal cable clamp

▼Humidity range

0...100% RH

(Non-condensing)

▼Temperature range

Wall type ▼

-40°C~80°C

Duct type ▼

-40°C ~ 120°C

Remote type ▼

-40°C~200°C

▼Screen display

LCD with backlight

Dual display

Height: 5.5mm

▼Probe

Material: SS304

Pressure resistant : 10 bar

▼Applicable media

Air

▼Work temperature

-20°C~80°C (body)

-20°C~60°C (with display)

▼Storage temperature

-25°C~60°C

▼Protection Level

Housing: IP65

Probe: IP20

Other Specifications**▼Housing**

Aluminum alloy

▼ Filter

S.S. metal grid filter with mesh

Sintered filter

▼Cable

Material: Teflon

Length: 2m, 5m

(Up to 10m in length)

▼Measurement Units

Temperature (T)

Humidity (H)

Dew point (D)

Frost point (F)

Wet-bulb Temp.(W)

Vapor pressure (E)

Mixture ratio (R)

Absolute humidity (A)

Specific enthalpy (S)

(Standard: T&H)

▼Output

0-20mA, 4-20mA

0~1V, 0~5V, 0~10V,

▼Humidity accuracy

0...90%RH ▼

Nonlinear error: $\pm 1.2\%RH$ Hysteresis error: $\pm 0.8\%RH$ Repeatability error: $\pm 0.4\%RH$ $\pm 2\%RH$ (0...100%RH)**▼Temperature accuracy** $\pm 0.15^\circ C$ **▼Response time (@25°C)**

< 20 sec (S.S. metal grid filter with mesh)

< 30 sec (Sintered filter)

▼Power supply

DC8~35V

AC12~30V

▼ Power consumption

DC24V: 60mA / DC12V:

120mA

AC24V: 140mA / AC12V:

230mA

▼Load resistance

Current output: Max. 500Ω

Voltage output: Min. 10KΩ

▼Weight

Wall type : 455g

Duct type : 521g

Remote type : 635g

Industrial High Accuracy Temp. & Humidity Transmitter

Model: AT-THM80 Series

Introduction

The AT-THM80 series industrial temperature and humidity transmitters can be installed in three different ways - wall-mounted, duct-mounted, and remote type, according to the environmental requirements. They can measure temperature and humidity ranging from $-40^\circ C$ to $200^\circ C$ and 0% to 100%RH. They are suitable for applications in semiconductor, clean rooms, industrial process monitoring, weather stations, and various environmental control areas.

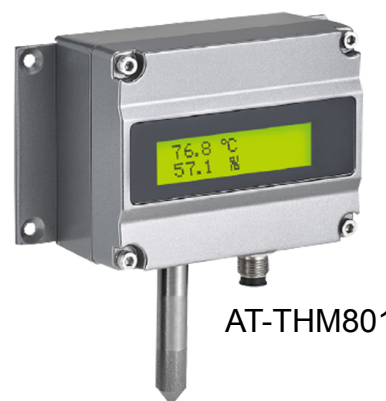

AT-THM801



Due to the variety of customization, the picture is only for reference, please confirm the actual item with our sales. (If there is any change on specification, please take the latest version as standard.)

Features

- Temperature compensation and computer linear calibration humidity function.
- Aluminum alloy sturdy casing, suitable for various harsh environments.
- High precision temperature and humidity measurement, good long-term stability.
- Switching between multiple units of physical quantities.
- Can plan various types of physical quantities, measurement ranges, analog output workstation numbers, etc.
- Measurement range can reach up to $200^\circ C$.
- Specialized planning software that can record data and analyze graphs.

Measuring Range List

Physical quantity	Wall type	Duct type	Remote type
Temperature(T)	-40°C~80°C	-40°C~120°C	-40°C~200°C
Humidity(H)	0~100%RH		
Dew point(D)	-40 dp °C~60 dp °C		
Frost point(F)	-40~0 fp °C		
Wet-bulb Temp.(W)	0~100°C		
Vapor pressure(E)	0~1100 mbar		
Mixture ratio(R)	0~999 g/kg		
Absolute humidity(A)	0~700 g/m³		
Specific enthalpy(S)	0~2800 kj/kg		

Electric Connector (Unit: mm)

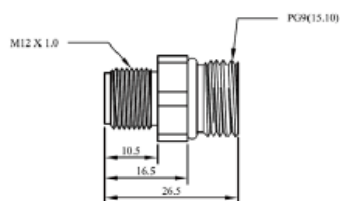

【M type (M12-4PIN connector)
RS-485 or analog】

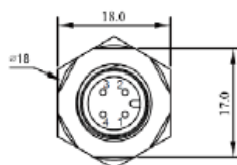

【M type (M12-8PIN connector)
RS-485+analog】

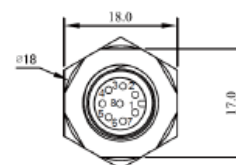

【N type (M16 cable gland)】

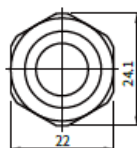
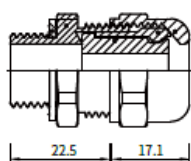

Dimension

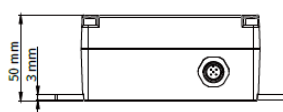
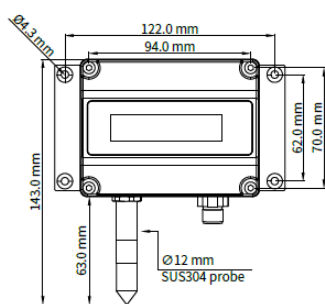

M type

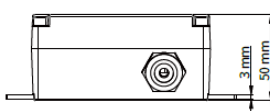

N type

AT-THM801

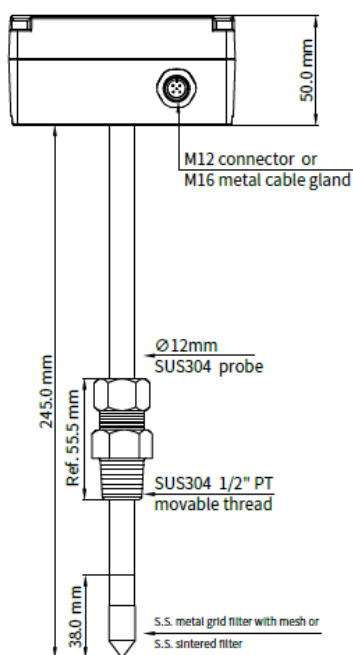

AT-THM802

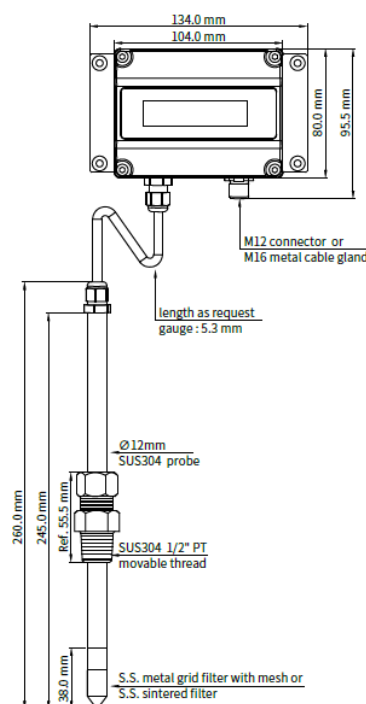

AT-THM803

How to order

AT-THM80 Series Industrial High Accuracy Temp. & Humidity Transmitter									
Std.	Spec.	Code	Item	Code	Item	Code	Item	Code	Item
3	Installation	1	Wall type	2	Duct type	3	Remote type	–	–
T&H	Output of physical units (Please choose two)	T	Temperature	H	Humidity	D	Dew point	F	Frost point
		W	Wet-bulb Temp.	E	Vapor pressure	R	Mixture ratio	A	Absolute humidity
		S	Specific enthalpy	–	–	–	–	–	–
Custom	Temperature range	-40°C~200°C							
1&9	Signal output (Please choose two)	1	4-20mA	2	0-20mA	6	0-10V	7	0-5V
		8	0-1V	9	RS-485	–	–	–	–
Y	Display	Y	Yes	X	No	–	–	–	–
M1	Electrical connector	M1	M12-4PIN connector	M2	M12-8PIN connector	N1	M16 metal cable clamp	–	–
S	Filter	M	S.S. metal grid filter with mesh	S	Sintered filter	–	–	–	–
2	Cable length	2	2 Meters	5	5 Meters	0	Others	–	–
/B	Other requests	/A	Third party notarized document						
		/B	Inspection report (issued by Re-Atlantis)						
		/C	Tag						

Order example: AT-THM803 - T&H - (0~150°C) - 1&9 - Y - M1 - S - 2 - /B